







Priced From
\$364,990

3 Elevations Available

-  **1,516+ Sq. Ft.**
-  **2 Bedrooms**
-  **2.5 Bathrooms**
-  **2 Car Garage**

The Rock home floor plan is proof that good things come in small packages. Rock is power packed with two bedrooms, two walk-in closets and the biggest kitchen in this collection. All that and it still offers a covered porch and a small nook off of the kitchen for whatever you need — space for pets, space for an office, it's up to you.



A



B



D

All square footage is approximate. Renderings are artist's conceptions and may vary slightly from the actual home. Homes may be built in reverse of plans shown, depending on site conditions. Minor architectural changes may be made occasionally at the option of the builder. Please contact your Sales Consultant for details.

First Floor

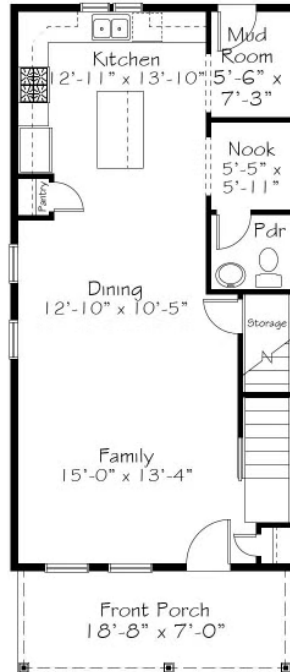

Second Floor

