



Priced From
\$370,000

2 Elevations Available

-  **1,978+ Sq. Ft.**
-  **3 - 4 Bedrooms**
-  **2.5 - 3.5 Bathrooms**
-  **1 Car Garage**

Aptly named after a brightly colored, deciduous flowering Southern shrub this home design offers delightful and vibrant open living spaces and a desirable first floor primary suite. A power-packed second floor has space for everyone without an ounce of unused space. Embrace living colorfully in the Azalea. Joyfully Built. Meaningfully Different.



A



B

All square footage is approximate. Renderings are artist's conceptions and may vary slightly from the actual home. Homes may be built in reverse of plans shown, depending on site conditions. Minor architectural changes may be made occasionally at the option of the builder. Please contact your Sales Consultant for details.

First Floor

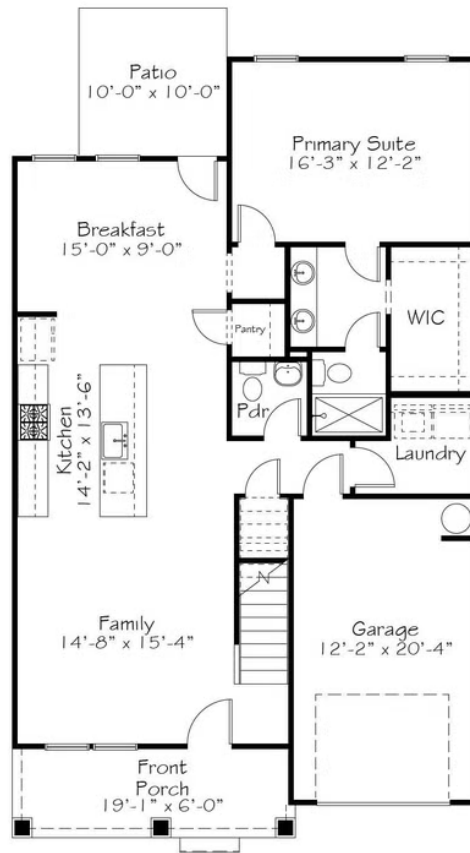

Second Floor

